

# Assembly & Installation Guide

## RB101-2: DOUBLE CROSSBAR KIT



### PLEASE READ INSTRUCTIONS FULLY PRIOR TO INSTALLATION OF CROSSBAR KIT

This instruction is to illustrate the recommended installation method for our Crossbar Kit, any deviation from this will be the sole responsibility of whoever carries out the installation.

**PLEASE ENSURE THAT THE MANUFACTURERS MAXIMUM ROOF LOADING IS NOT EXCEEDED**  
(Refer to vehicle handbook)

**REGULARLY INSPECT CROSSBARS AND FEET BRACKETS ENSURING ALL FIXINGS ARE SECURE**

### TOOLS REQUIRED (Not included within kit)

13mm SPANNER - x2

FLAT HEAD SCREWDRIVER

TAPE MEASURE

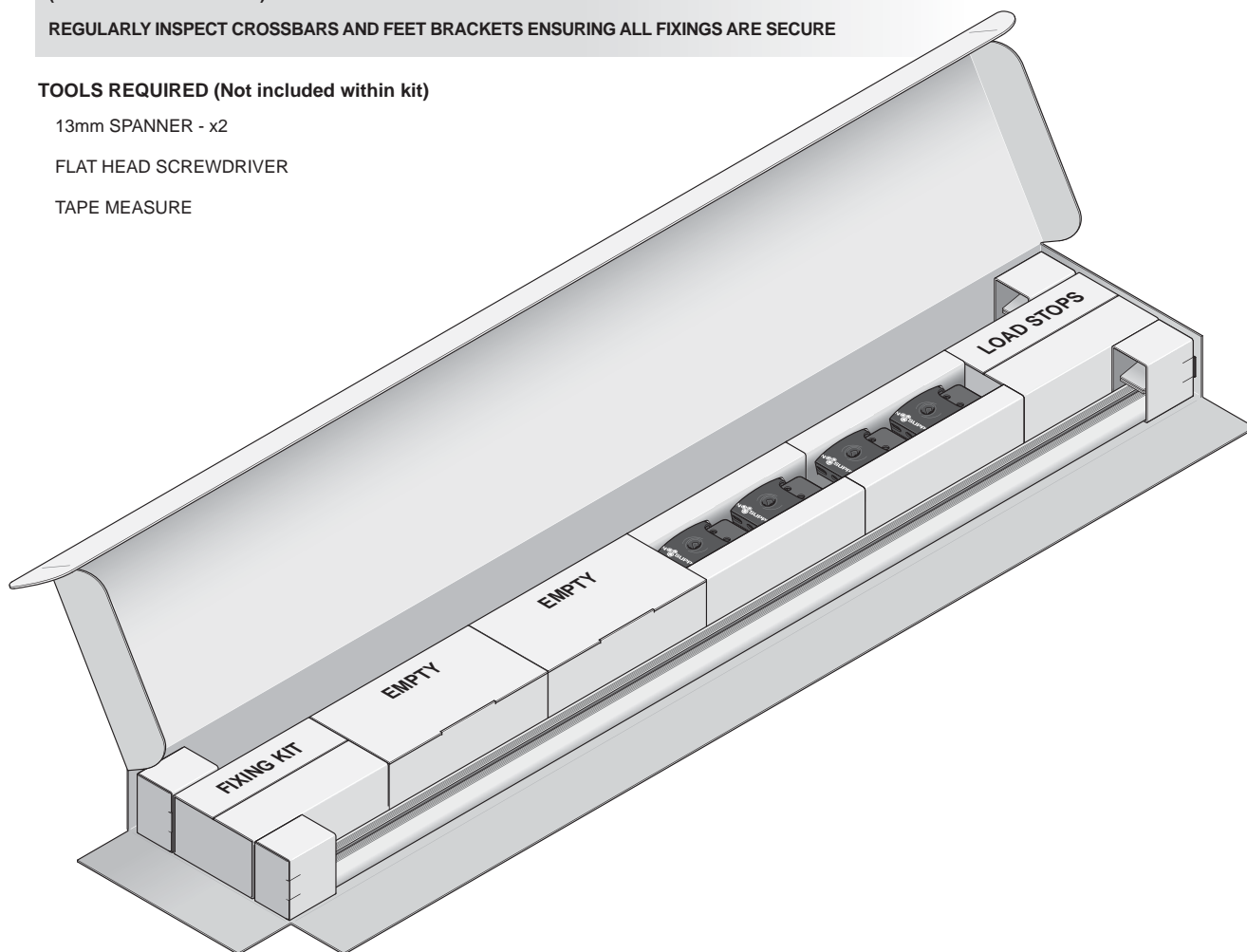

THE ABOVE DIAGRAM ILLUSTRATES COMPONENTS AS SUPPLIED IN A DOUBLE CROSSBAR KIT PACKAGE

### PARTS LIST ILLUSTRATED RELATES TO COMPONENTS SUPPLIED WITHIN RB101-2 EACH PHASE OF THE INSTALLATION WILL ILLUSTRATE ITEMS REQUIRED

SCALE OF ITEMS WILL VARY TO AID VISUAL IDENTIFICATION

Ensure all the items listed are present, open each Fixing Kit Bag when instructed

1350mm CROSSBAR - x2

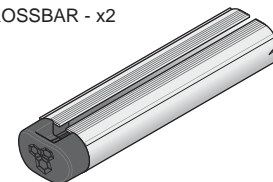

FIXING KIT 6 - x1



FIXING KIT 9 - x1



LOCK KIT - x1

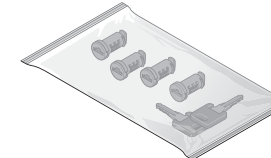

T1 FOOT PACKER - x2

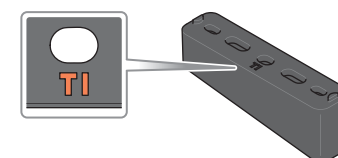

T2 FOOT PACKER - x2

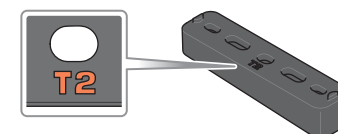

H1 FOOT GASKET - x4

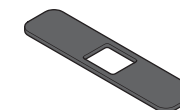

FOOT BRACKET COVER - x4



FOOT BRACKET - x4

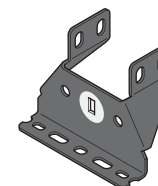

SADDLE CLAMP - x4

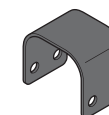

LOAD STOP - x4



# Assembly & Installation Guide

## RB101-2: DOUBLE CROSSBAR KIT



### PHASE 1: REAR CROSSBAR INSTALLATION



COMPLETE THE FOUR PROCEDURES DETAILED AND MOVE ONTO PHASE 2.

INSTALLATION OF THE REAR CROSSBAR WILL BE COMPLETED AT A LATER STAGE

#### 'FIXING KIT 6' IS REQUIRED FOR THIS PHASE

##### Fixing Kit 6 Contains:

FK1: M8 x 45mm SET - x2

FK2: M8 x 85mm SET - x4

FK3: M8 SPRING WASHER - x2

FK4: M8 FORM C WASHER - x10

FK5: M8 NYLOC NUT - x4

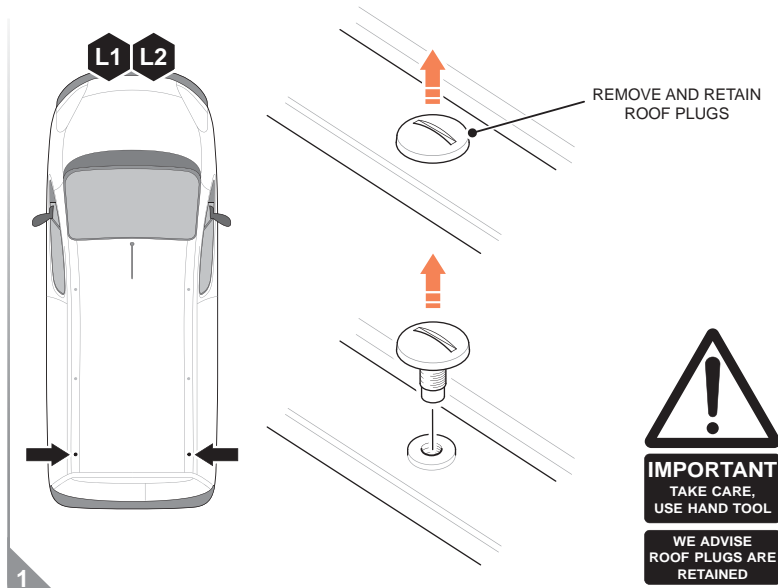
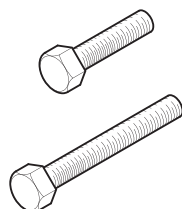

REMOVE ROOF PLUG AT LOCATIONS INDICATED '➡' USING A FLAT HEAD SCREWDRIVER. TAKE CARE WHEN REMOVING ROOF PLUGS, IT IS ADVISABLE TO EASE OUT WITH A HAND TOOL.

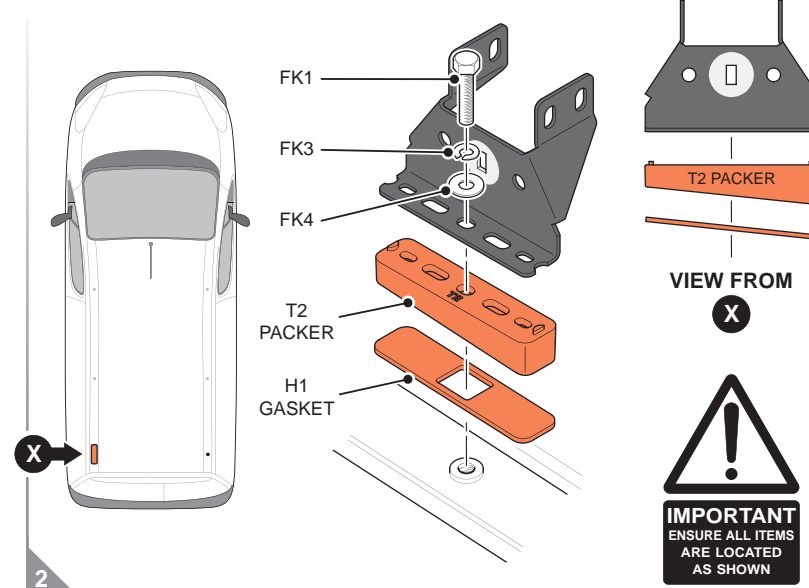

LOCATE FOOT BRACKET ONTO VEHICLE AS SHOWN AT LOCATION INDICATED 'X➡'. NOTE: FEET BRACKETS ARE IDENTICAL SO CAN BE FITTED EITHER SIDE OF VEHICLE.

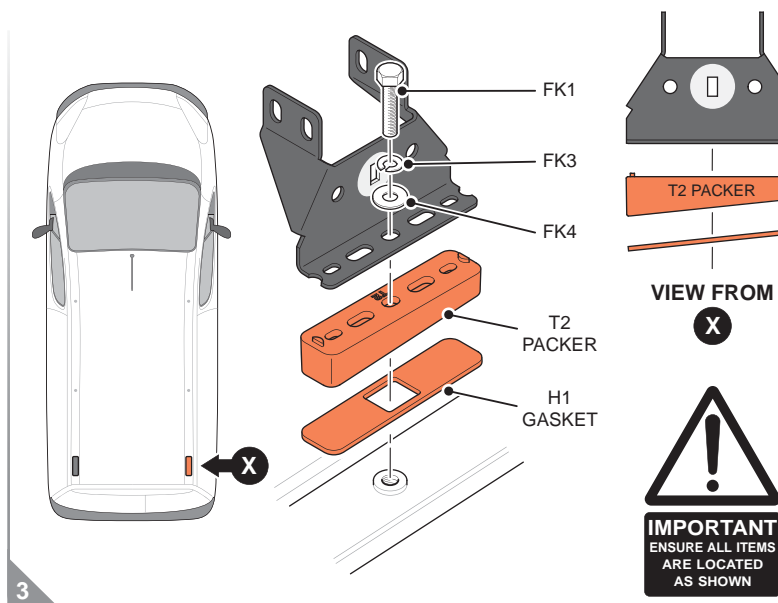

LOCATE FOOT BRACKET ONTO VEHICLE AS SHOWN AT LOCATION INDICATED 'X➡'.

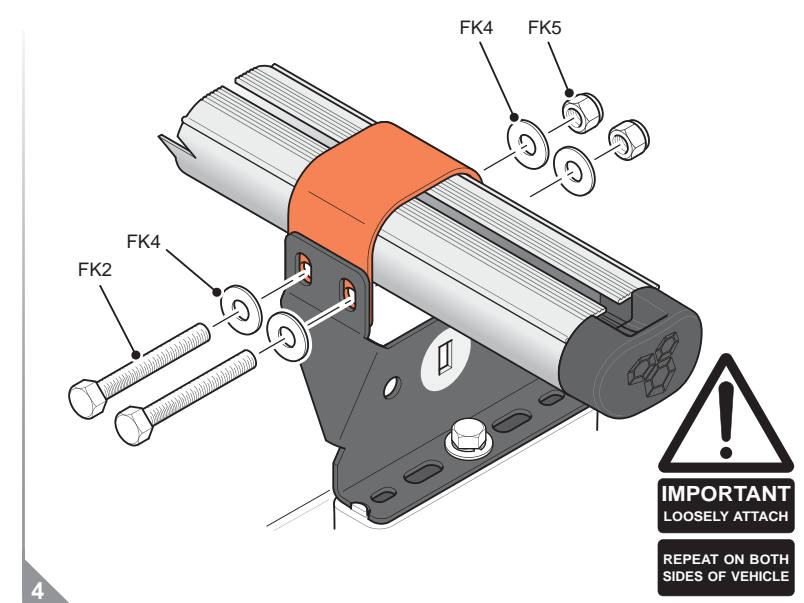

A: LOCATE CROSSBAR INTO EACH FOOT BRACKET ENSURING CROSSBAR SLOT IS AT THE TOP.  
B: POSITION SADDLE CLAMP AS SHOWN AND LOOSELY ATTACH ONTO FOOT BRACKET.

# Assembly & Installation Guide

## RB101-2: DOUBLE CROSSBAR KIT



### PHASE 2: FRONT CROSSBAR INSTALLATION



COMPLETE THE FOUR PROCEDURES DETAILED AND MOVE ONTO PHASE 3.  
INSTALLATION OF THE FRONT CROSSBAR WILL BE COMPLETED AT A LATER STAGE

#### 'FIXING KIT 9' IS REQUIRED FOR THIS PHASE

##### Fixing Kit 9 Contains:

FK1: M8 x 60mm SET - x2

FK2: M8 x 85mm SET - x4

FK3: M8 SPRING WASHER - x2

FK4: M8 FORM C WASHER - x10

FK5: M8 NYLOC NUT - x4

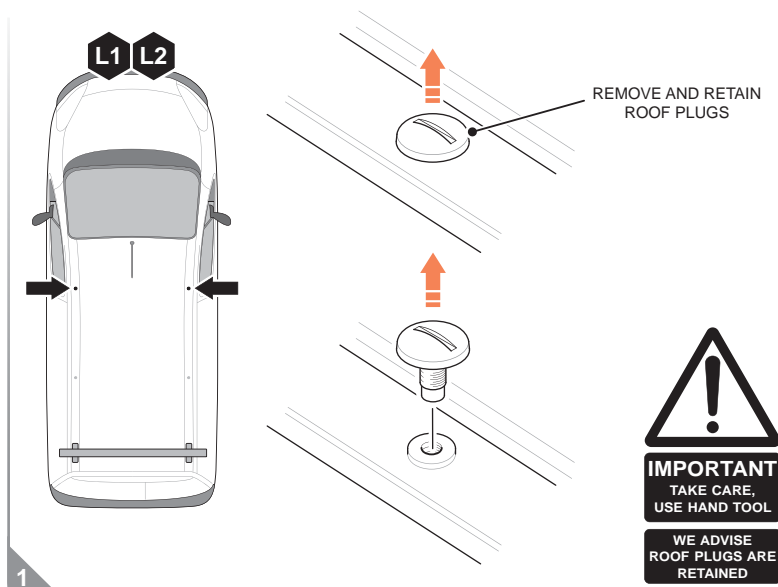
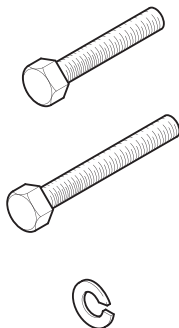

REMOVE ROOF PLUG AT LOCATIONS INDICATED '➡' USING A FLAT HEAD SCREWDRIVER.  
TAKE CARE WHEN REMOVING ROOF PLUGS, IT IS ADVISABLE TO EASE OUT WITH A HAND TOOL.

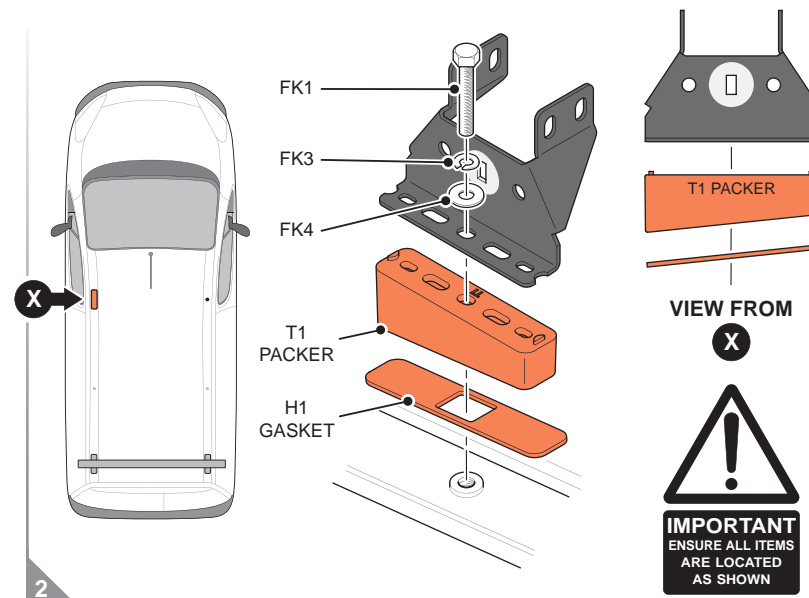

LOCATE FOOT BRACKET ONTO VEHICLE AS SHOWN AT LOCATION INDICATED 'X➡'.  
NOTE: FEET BRACKETS ARE IDENTICAL SO CAN BE FITTED EITHER SIDE OF VEHICLE.

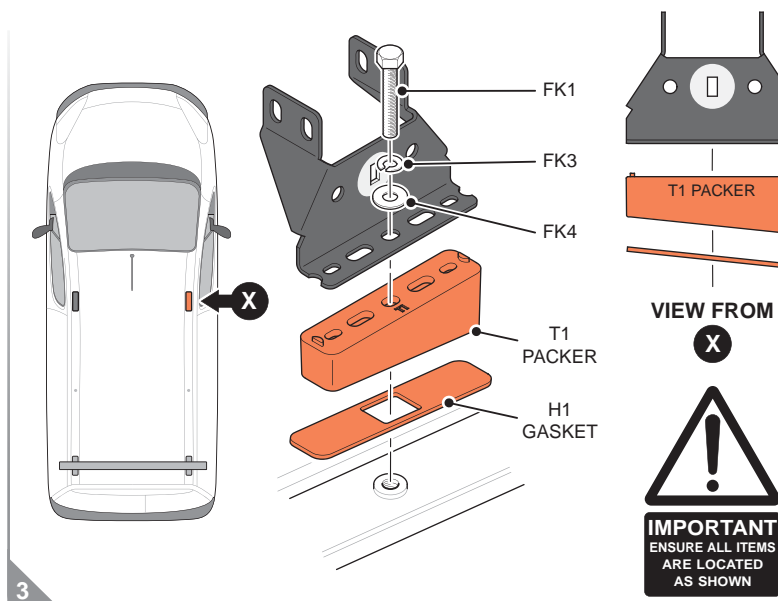

LOCATE FOOT BRACKET ONTO VEHICLE AS SHOWN AT LOCATION INDICATED 'X➡'.

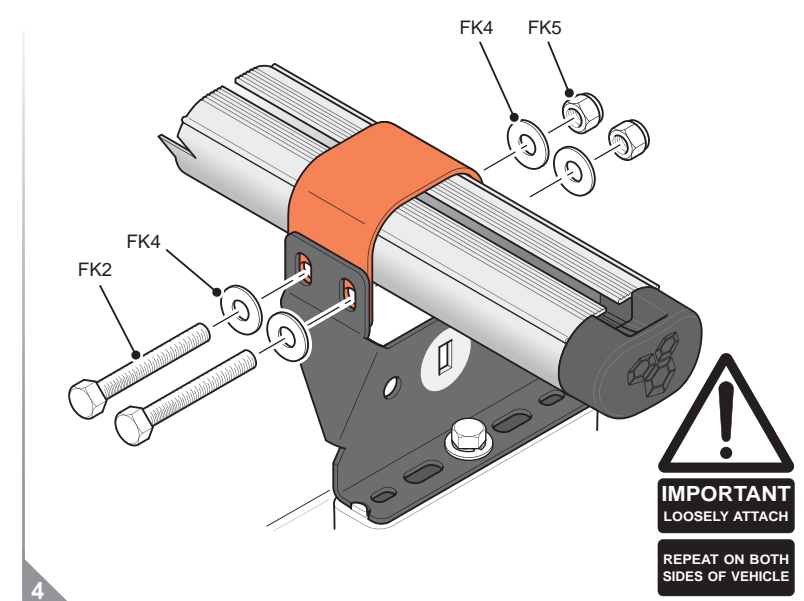

A: LOCATE CROSSBAR INTO EACH FOOT BRACKET ENSURING CROSSBAR SLOT IS AT THE TOP.  
B: POSITION SADDLE CLAMP AS SHOWN AND LOOSELY ATTACH ONTO FOOT BRACKET.

# Assembly & Installation Guide

## RB101-2: DOUBLE CROSSBAR KIT



### PHASE 3: COMPLETION OF CROSSBAR KIT INSTALLATION

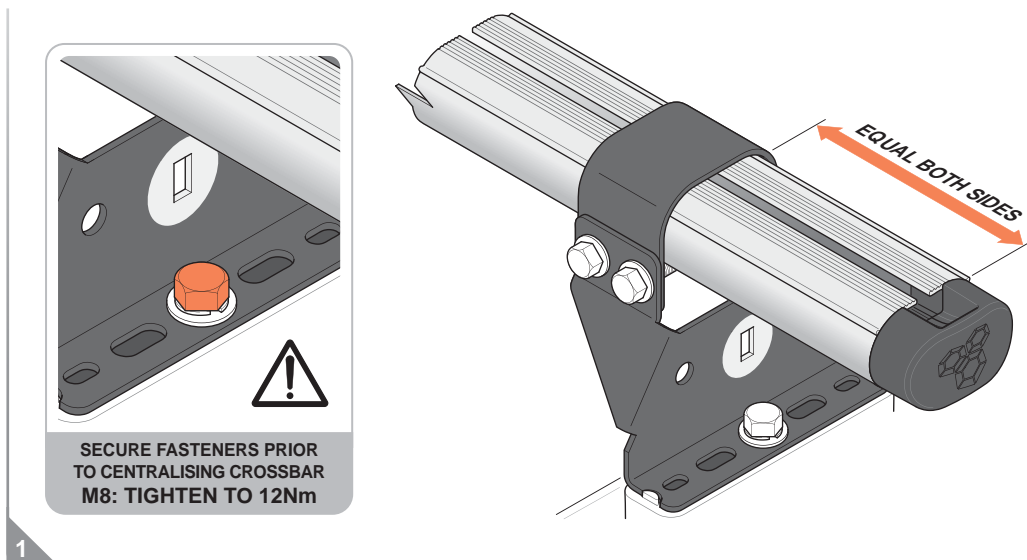

SECURE FASTENERS PRIOR TO CENTRALISING CROSSBAR  
M8: TIGHTEN TO 12Nm

**A: IMPORTANT, SECURE ALL FEET BRACKET FASTENERS TO THE TORQUE SETTING GIVEN ABOVE.**  
**B: ADJUST EACH CROSSBAR TO ENSURE THEY ARE CENTRAL AND ACHIEVE AN EQUAL DISTANCE EACH SIDE OF SADDLE CLAMP.**

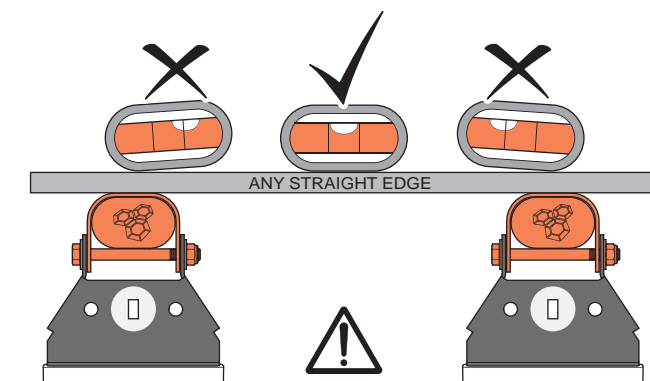

**2**

ENSURE ALL CROSSBAR ASSEMBLIES ARE LEVEL  
USE A STRAIGHT EDGE THAT SPANS ALL CROSSBARS

**A: USING A STRAIGHT EDGE THAT SPANS ALL CROSSBARS, ADJUST SADDLE CLAMPS TO ENSURE CROSSBARS ARE LEVEL.**  
**B: IMPORTANT, SECURE ALL SADDLE CLAMP FASTENERS TO THE TORQUE SETTING GIVEN ABOVE.**

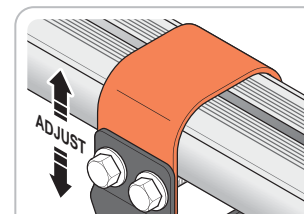

ADJUST SADDLE CLAMP TO  
ACHIEVE LEVEL CROSSBARS

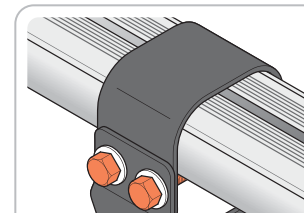

ALL M8 FASTENERS:  
TIGHTEN TO 12Nm

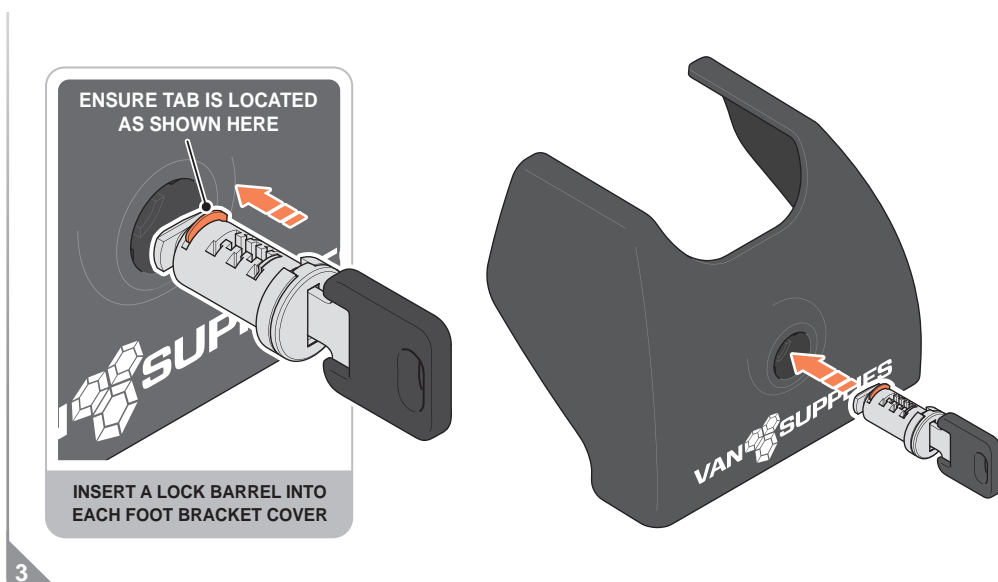

ENSURE TAB IS LOCATED  
AS SHOWN HERE

INSERT A LOCK BARREL INTO  
EACH FOOT BRACKET COVER

LOCATE A LOCK BARREL INTO EACH FOOT BRACKET COVER, ENSURE TAB IS LOCATED AS DETAILED.

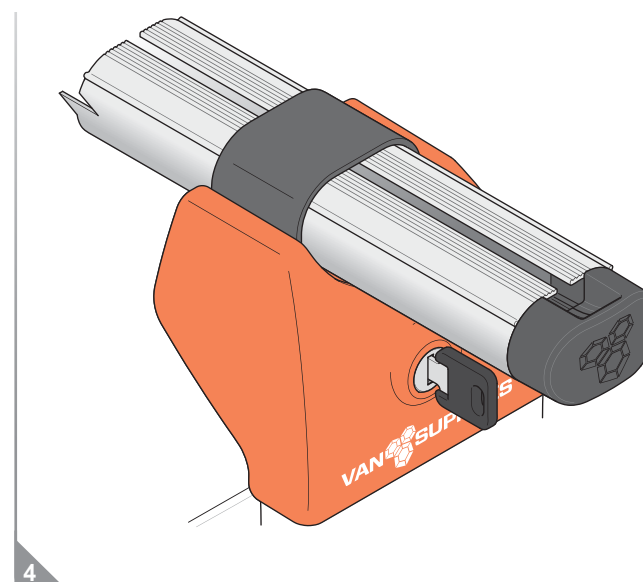

ROTATE LOCK BARREL 90°  
ANTI-CLOCKWISE TO LOCK

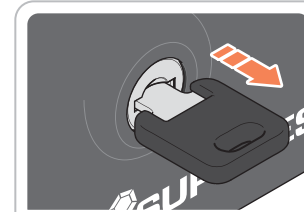

REMOVE KEY AND REPEAT ON ALL  
REMAINING FEET BRACKETS

**A: LOCATE FOOT BRACKET COVER ONTO EACH FOOT BRACKET ASSEMBLY AS SHOWN.**  
**B: ROTATE LOCK BARREL 90° ANTI-CLOCKWISE TO LOCK IN POSITION AND REMOVE KEY.**

# Assembly & Installation Guide

## LSN2: LOAD STOP KIT (1 PAIR)



### LOAD STOP KIT (1 PAIR) INSTALLATION

#### PLEASE READ FULLY PRIOR TO INSTALLATION

This instruction illustrates the recommended installation method for our Load Stops, any deviation from this will be the sole responsibility of whoever carries out the installation.



USING THE TYPICAL INSTALLATION METHOD SHOWN, LOAD STOPS CAN BE LOCATED AS DESIRED ON ANY VAN SUPPLIES CROSSBAR



THESE LOAD STOPS ARE NOT DESIGNED TO SECURE LOADS, PLEASE ENSURE ANY LOAD IS SECURE PRIOR TO ANY MOVEMENT OF VEHICLE



TYPICALLY LOAD STOPS ARE LOCATED ON THE FRONT AND REAR CROSSBARS, TWO ON EACH

#### ONE LOAD STOP KIT CONTAINS:

SCALE MAY VARY TO AID VISUAL IDENTIFICATION

LOAD STOP - x2



LOAD STOP KNOB - x2



M8 x 35mm SET - x2



LOCK NUT - x2

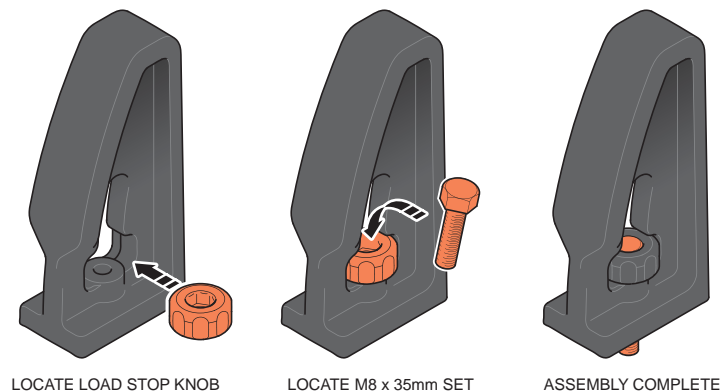

1

A - ENSURING LOAD STOP KNOB IS IN CORRECT ORIENTATION LOCATE AS SHOWN.  
B - LOCATE M8 x 35mm SET THROUGH LOAD STOP KNOB AND INTO LOAD STOP.

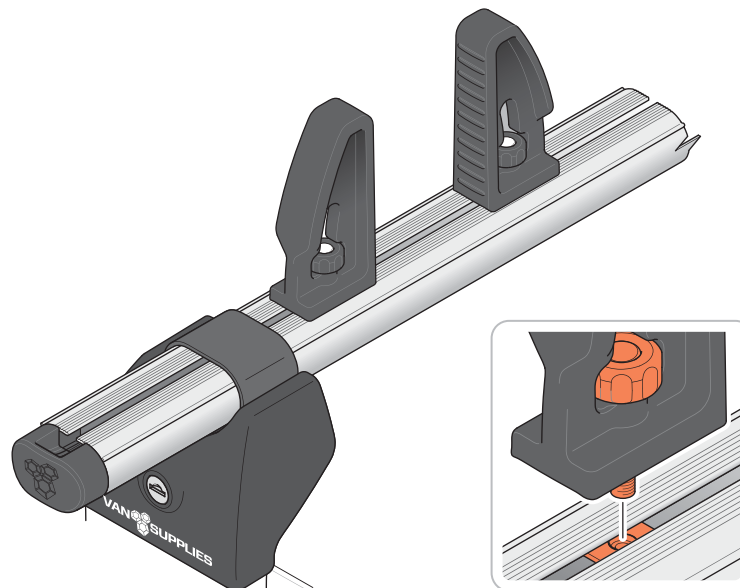

3

ALIGN LOAD STOP ASSEMBLIES WITH LOCK NUTS AND LOOSELY ATTACH, THESE CAN BE LOCATED AT ANY POINT ALONG CROSSBAR AND IMAGE ABOVE IS USED FOR ILLUSTRATION PURPOSE ONLY.

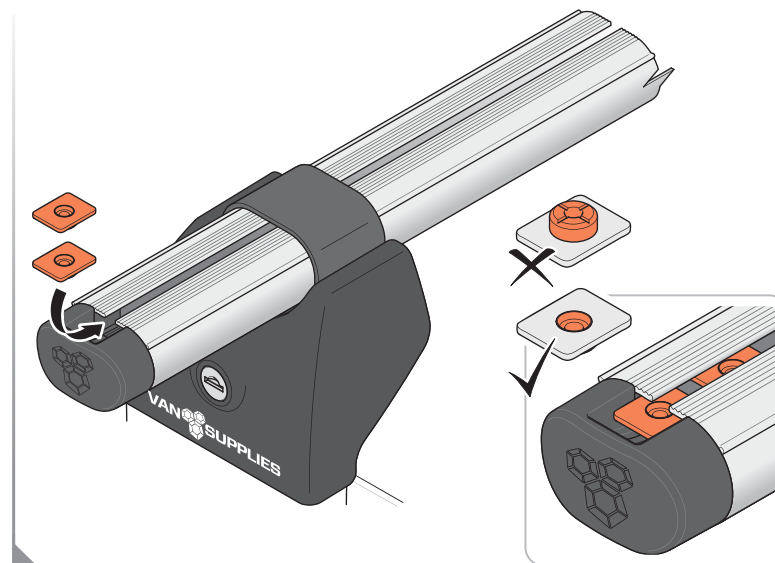

2

LOCATE x2 LOCK NUTS INTO DESIRED CROSSBAR AS SHOWN ABOVE

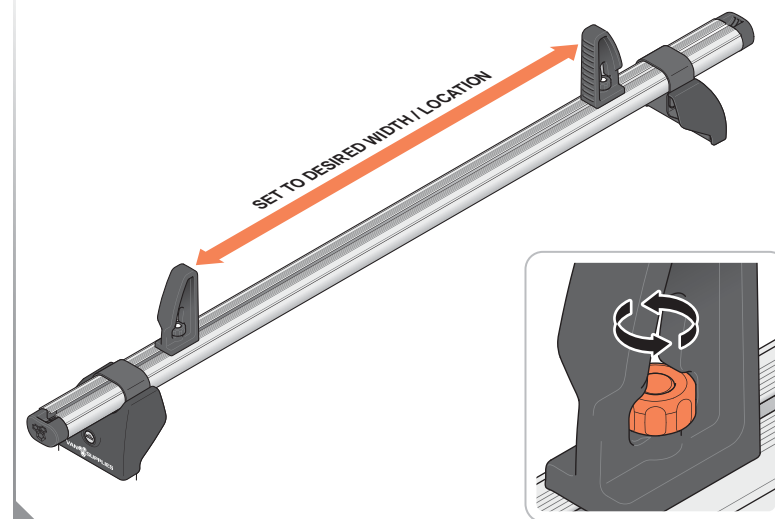

4

A - LOCATE LOAD STOPS TO DESIRED WIDTH / LOCATION.  
B - IMPORTANT, TIGHTEN FASTENERS AND ENSURE ALL LOAD STOPS ARE SECURE.